



NESBA Dover Winter Guard and Percussion Show 3/5/23

Director's Packet:

Welcome to the Dover Winter Guard and Percussion Show! Our School is located at 25 Alumni Drive in Dover, NH.

Drop off: All teams (Buses, Trucks and U-Haul's) should drop off at the loading dock behind the school, off Daley Drive. Buses can then loop back around school to park on Daley Drive. Equipment trucks will unload instruments and equipment at the loading dock, props will be left at the aux gym entrance beyond, then park in the drop off lane on Alumni Drive. Attached please find a map of our campus.

Show Participation Fee: please submit \$75 payment per team. Payment methods listed on invoice.

Check in: Rear loading dock doors open to our first teams at **10:15am**. If possible, we would appreciate it if teams could arrive during their drop off times.. This will help us have enough space for everyone's equipment, props and team members. Each team will be assigned a meeting area on the 2nd Floor mezzanine. Thanks!

Percussion Storage Area: will be assigned to you at arrival. The first two groups will unload straight to practice rooms.

Percussion Practice Areas: teams will be either in the Band Room or on the Stage.

Guard Practice Areas: Body warm-ups on Stage, Band Room & Aux Gym.

Rest rooms: are located next to the cafeteria on the upper and lower levels. Gender neutral bathrooms are located in the music wing.

Changing rooms: Locker rooms in the gym corridor are available for changing only. ITEMS MAY NOT BE STORED IN LOCKER ROOM.

Concessions: homemade breakfast and lunch items will be provided in the cafeteria, cash paypal or venmo accepted. Food and drink are allowed in the cafeteria ONLY. (cash paypal or venmo accepted)

Admissions: \$10 adults, \$8 65+ and students, 5 and under FREE. Doors open at 11:30am.

Raffles: Tickets will be sold outside the gym entrance in the cafeteria. Raffle prizes include a gift card basket worth over \$800 (tickets \$10 each, do not need to be present to win) Smaller raffle prize ticket prices will vary.

Awards: will be given out at the conclusion of percussion and guard events; 1st-3rd place medals will be awarded per NESBA judges scoring

Need Help? Find a parent volunteer with a Dover Music lanyard and they will assist you.

Thank you for participating in our show and supporting DHS music and guard!

Best of luck to all teams!

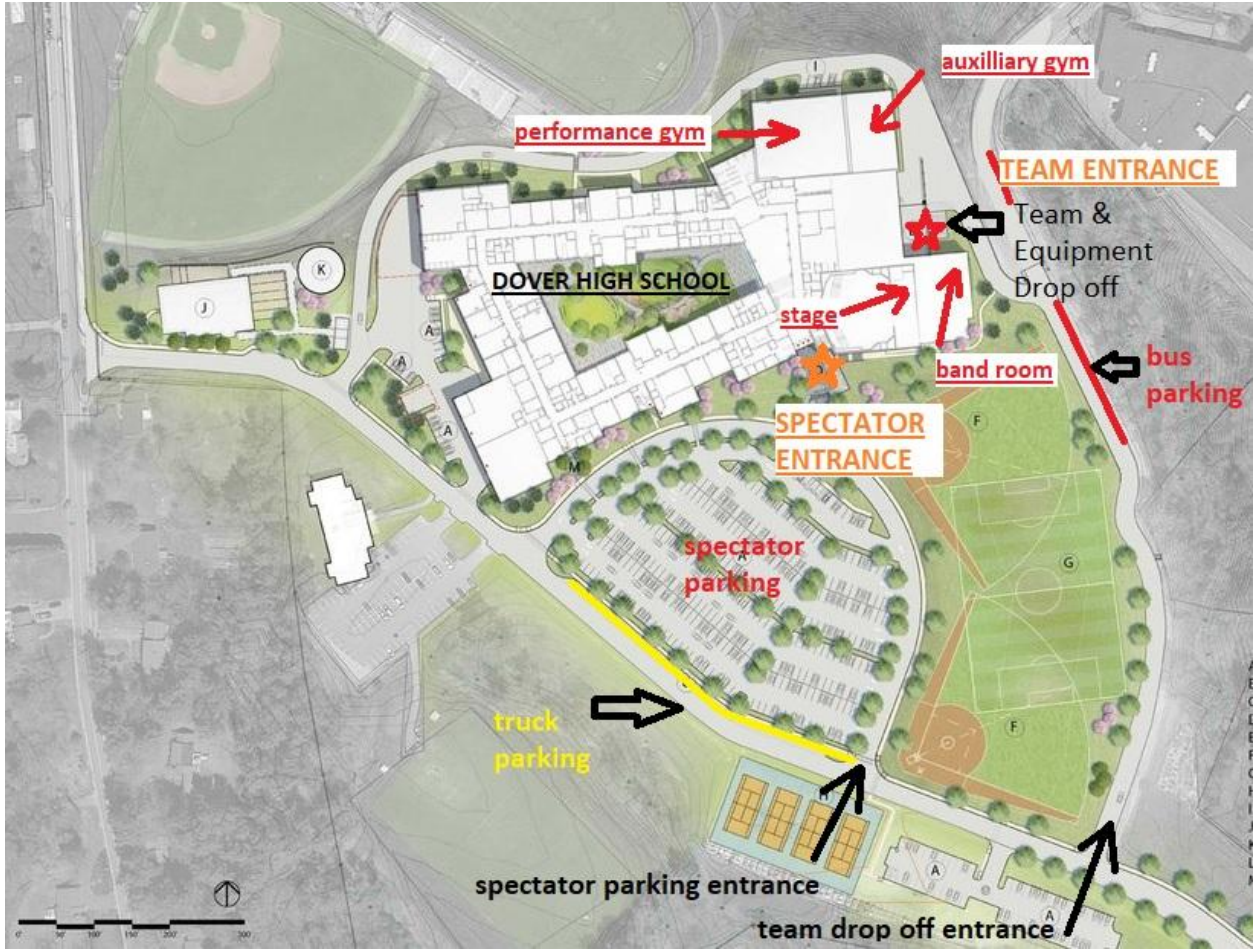

Invoice for Dover High School NESBA Winter Competition 3/5/23

Invoice Date: 2/12/23

Dover Parents' Music Club
P.O. Box 1545 Dover, N.H. 03821-1545
copresident1@dpmcnh.org

Tax ID: #23-7100708

Please remit **\$75.00** per performing group. Payment options:

- **preferred method of payment:**
[WINTER SHOW | dpmc \(bandshow1.wixsite.com\)](http://bandshow1.wixsite.com/dpmc)
(please visit our website link above or visit “dpmcnh.org”, under “events” and “winter show”. You can adjust the payment fee from their suggested amount if you do not wish to pay the fee)
- **optional method:**
mail check made out to “DPMC” to
Dover Parents' Music Club
P.O. Box 1545
Dover, NH 03821-1545
(*please mail by 2/24/23*)

This fee must be prior to the competition on March 5, 2023.

Thank you, and we look forward to your performance!

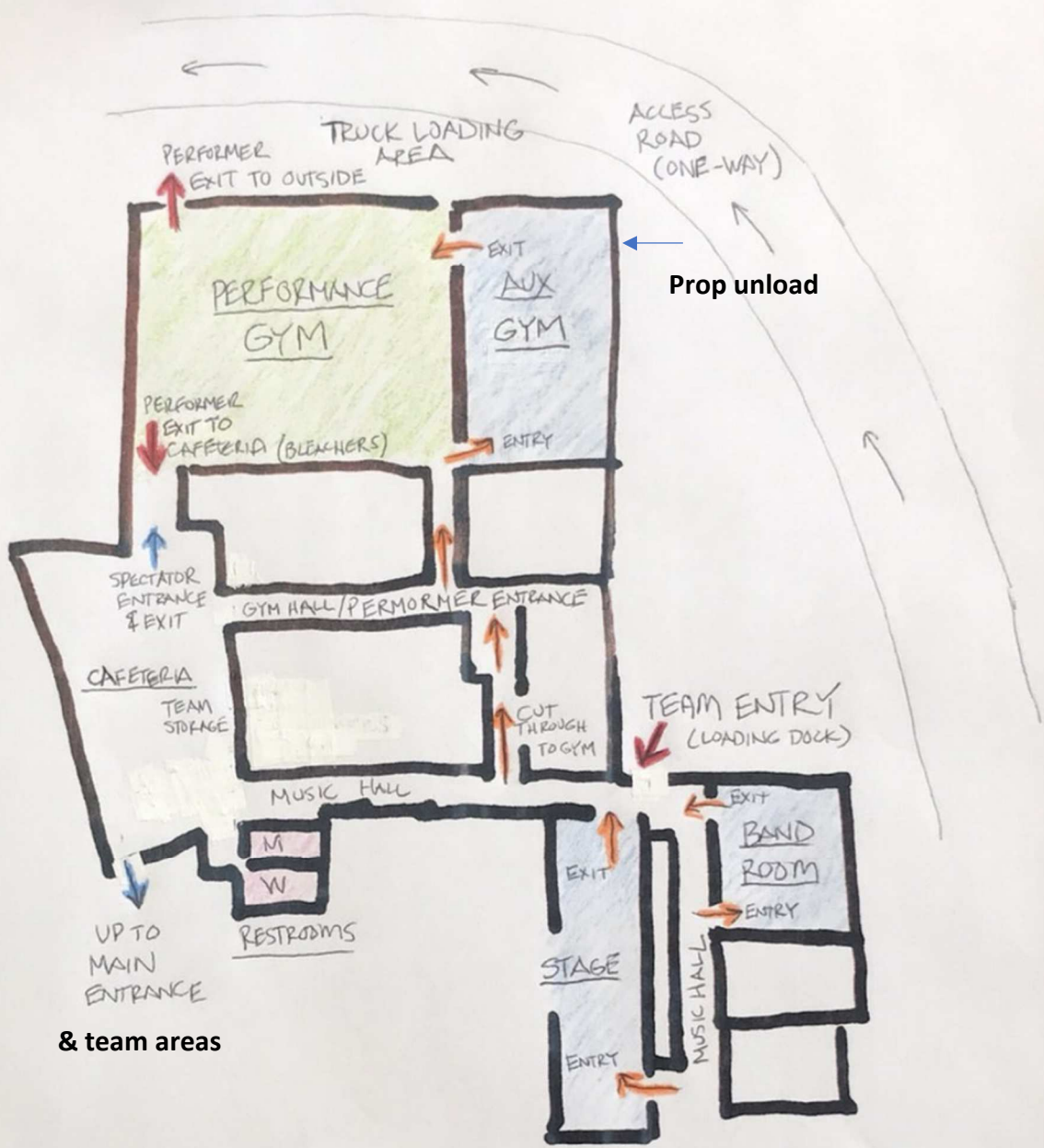

& team areas

DOVER HIGH SCHOOL
LOWER LEVEL
PERFORMANCE AREA MAP

Dover High School Winter Show 2023

PERCUSSION	Division	Unload time	Warm up Area	Warm up Time	Transit to Aux Gym*/ Prop Area	Ready in Aux Gym	Perform	
Biddeford High School	WSA	10:00-10:15	band room	11:15	11:35	11:50	12:00	
Dennis-Yarmouth Winter Percussion	PSA	10:10-10:25	stage	11:25	11:45	12:00	12:10	
Wakefield HS Winter Percussion	PSA	10:20-10:35	band room	11:35	11:55	12:10	12:20	
Marshwood HS Winter Percussion	PSA	10:30-10:45	stage	11:45	12:05	12:20	12:30	
Sanford HS Winter Percussion	PSA	10:40-10:55	band room	11:55	12:15	12:30	12:40	
BREAK							12:50	
Shepherd Hill HS Winter Percussion	PSAA	10:45-11:00	stage	12:15	12:35	12:50	1:00	
Londonderry HS Winter Percussion	PSAA	10:55-11:10	band room	12:25	12:45	1:00	1:10	
Westbrook HS Winter Percussion	PSAA	11:05-11:25	stage	12:35	12:55	1:10	1:20	
Dover HS Winter Percussion	PSAA	11:15-11:30	band room	12:45	1:05	1:20	1:30	
Biddeford High School Winter Percussion	PSAA	11:25-11:40	stage	12:55	1:15	1:30	1:40	
AWARDS							1:50	
GUARD	Division	Unload time	Body Warm up	Warm up Time	Transition	Equipment Warm Up Aux Gym*	Ready in Aux Gym	Perform
Danvers HS Winter Guard	NC	12:25-12:40	stage	2:03	2:11	2:17	2:25	2:35
Wells JHS Winter Guard	MS	12:30-12:45	stage	2:11	2:19	2:25	2:33	2:43
Marshwood HS Winter Guard	LSRA	12:35-12:50	stage	2:19	2:27	2:33	2:41	2:51
Sanford HS Winter Guard	LSRA	12:40-12:55	stage	2:27	2:35	2:41	2:49	2:59
BREAK								3:07
South Portland HS Winter Guard	SRA	1:10-1:25	stage	2:45	2:53	2:59	3:07	3:17
Wells HS A Team Winter Guard	SRA	1:15-1:30	stage	2:53	3:01	3:07	3:15	3:25
Triton HS Winter Guard	SRA	1:20-1:35	stage	3:01	3:09	3:15	3:23	3:33
Methuen HS Winter Guard	SRA	1:25-1:40	stage	3:09	3:17	3:23	3:31	3:41
Westbrook HS Winter Guard	SRA	1:30-1:45	stage	3:17	3:25	3:31	3:39	3:49
North Middlesex HS Winter Guard	SAA	1:35-1:40	stage	3:25	3:33	3:39	3:47	3:57
Shepherd Hill HS Winter Guard	LSA	1:40-1:55	stage	3:33	3:41	3:47	3:55	4:05
Dover HS Winter Guard	LSA	1:45-2:00	stage	3:41	3:49	3:55	4:03	4:13
BREAK								4:21
Maine Attraction	IRA	2:15-2:30	stage	3:59	4:07	4:13	4:21	4:31
Salem Blue Winter Guard	NSA	2:20-2:35	stage	4:07	4:15	4:21	4:29	4:39
Billerica Memorial HS Winter Guard	NSA	2:25-2:40	stage	4:15	4:23	4:29	4:37	4:47
AWARDS								4:57

*You must enter the main gym to get to the aux gym. Please be quiet and respectful of performing teams as you pass through.